

## Lahti (FIN) – 3-4/03/2018

### Competition Program

Date	Format	Distance	Remarks
03/03/2018	Sprint F	1.4km / 1.6 km	Karpalo Sprint
04/03/2018	Interval Start C	10km / 15km	5 km course (2,5kmNorth+2,5kmSouth)

### Event Program

Date	Competition	TCM	Other
Friday 2/3/2018		17:00 Lahti Hall (Exhibition Center)	TBD Bib ceremony Sprint L+M
Saturday 3/3/2018	11:45 Sprint Quali F 14:15 Sprint Finals	19:00 Lahti Hall (Exhibition Center)	Prize Giving ceremony after the race
Sunday 4/3/2018	12:15 10 km C Ladies 13:45 15 km C Men		Prize Giving ceremony after the race

### Contacts

Office	Name	Telephone	Email
General Secretary	Jesse Kiuru	+358 50 585 7441	jesse.kiuru@lahtiskigames.com
Accommodation office	Suvi Kainulainen	+358 50 371 0512	teamservice@lahtiskigames.com
Transportation office	TBA		teamservice@lahtiskigames.com
Race office	Raiko Pousi (Chief of competition)	+358 40 758 9851	crosscountry@lahtiskigames.com
Financial office	Anne Lahdelma	+358 45 168 9028	anne.lahdelma@hihtoliitto.fi
Wax Cabins	TBC		crosscountry@lahtiskigames.com

<b>Truck driving permission</b>	TBC	crosscountry@lahtiskigames.com
---------------------------------	-----	--------------------------------

## Offices and their opening times

Office	Location	Opening times
<b>Race office</b>	CC Stadium, Grandstand Building, Field level (Entrance 2)	Thu 28.2: 10:00-18:00 Fri-Sat 9:00-20:00, Sun 4.3: 10:00-18:00
<b>Transportation and Accommodation office</b>	CC Stadium, Grandstand Building, Field level (Entrance 2)	Mon-Tue 26.-27.2: 10:00 - 15:00, Wed-Thu 28.2.-1.3. 10:00 - 18:00, Fri -Sat 1.- 3.3. 8:00-20:00, Sun 4.3: 9:00-19:00
<b>Accreditation office</b>	Lahti Exhibition Centre, Lahti Hall (downstairs)	Tue 27.2:12:00 - 19:00, Wed-Fri 28.2-1.3.: 9:00 - 19:00, Sat 2.3: 8:00 - 18:00, Sun 3.3: 8:00 - 14:00
<b>Financial office</b>	CC Stadium, Grandstand Building, Field Level (Entrance 2)	from Friday 2.3. to Sunday 4.3. at 10:00 - 17:00.

## Logistical information

- Additional information about the accommodation will be given to the teams after receiving preliminary entry and accommodation request.
- Price for additional accommodation outside of the quota: 125 CHF / person / night (full board)
- Price for additional single rooms outside of the quota on request (contact teamservice@lahtiskigames.com) : Scandic Lahti 175€ / room / night (full board), Vierumäki Resort Hotel 165€ / room / night (full board)

## Transport (World Cup Rules Art. 11)

- Official airport : Helsinki-Vantaa Airport
- OC Lahti will arrange transportation between the airports and the hotels. 1 transport (from and to the airport) free of charge. Price for additional transport (up to 7 people 140 €, 8-17 persons 205 €).
- Information to Shuttle Service provided by OC Lahti:
- (Vierumäki Resort Hotel – Venue – Vierumäki Resort Hotel / Scandic Lahti – Venue – Scandic Lahti : Schedule will be informed later

### **Payment (World Cup Rules Art. 10 and 13)**

- Accommodation costs: Persons from the pay lists will be paid by the OC directly. Other accommodation costs to be paid at accommodation / financial office. Over quota costs will be reduced from the Travel Money.
- Carrying costs/Reimbursement :
- Expenses sheets will be received in financial office during the race weekend or by e-mail: [anne.lahdelma@hiihtoliitto.fi](mailto:anne.lahdelma@hiihtoliitto.fi). Payments will be done by bank transfer.

### **Waxing facilities (World Cup Rules Art. 14)**

- Wax cabins: available from Tue 27/2/2018 at 12:00
- Waxing trucks: teams arriving with trucks have to inform the OC before 19/1/2018
- Keys to cabins are available at the competition office. The deposit is 100 € / team. Keys return to CC Service Area on the day of departure.
- Parking cards can be picked up at the CC Service Area office same time with the keys.

### **Regulations of radio equipment:**

- The import, export and the operation of radio equipment in Finland is regulated by national law. Permits for the use of radio transmission equipment must be requested according to national specifications.
- More Information : [www.ficora.fi](http://www.ficora.fi)

### **Regulations of Visa:**

- Remember that citizens of some countries will need visa for visiting Finland. Please check with your embassy if you need a visa for Finland.
- For an official letter of invitation, please send a request to [teamservice@lahtiskigames.com](mailto:teamservice@lahtiskigames.com)

### **Special permissions for truck driving (Sunday- and night, other days with special regulations)**

- Teams must give information when they will arrive to stadium and parking area. Send messages by email to [teamservice@lahtiskigames.com](mailto:teamservice@lahtiskigames.com)
- No Sunday or night driving permission needed

### **Income tax information for prize money:**

- Income tax of European citizen is 15%
- Income tax of non-European citizen is 15% (USA 0 %)

### **Course Maps**

- Sat 3.3.: Karpalo Sprint / Ladies 1,4 km, Men 1,6 km
- Sun 4.3.: 2,5 km North + 2,5 km South -> 5 km loop

## Karpalo Sprint courses 1,4 km / 1,6 km

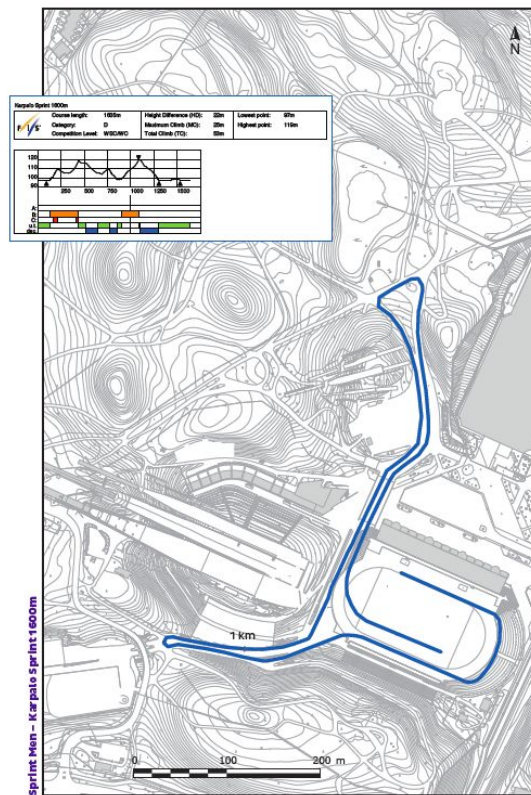
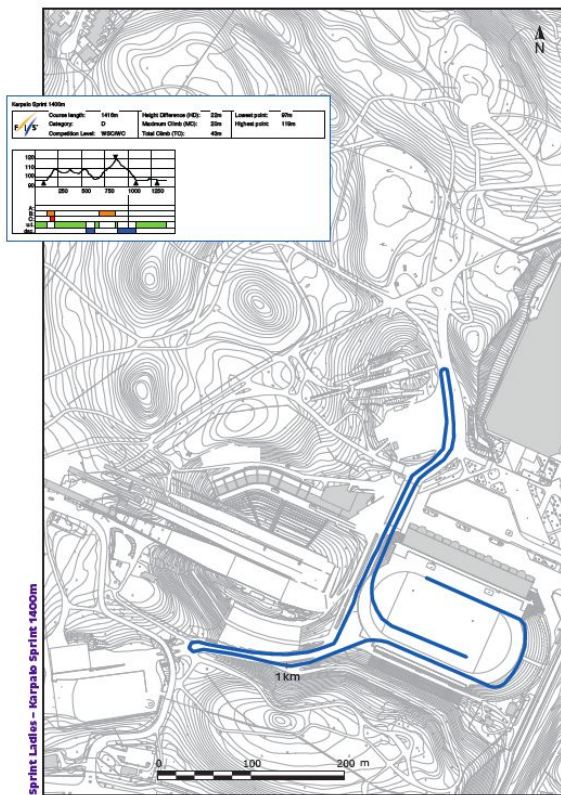

## Lahti 5 km course (2,5 km north + 2,5 km south)

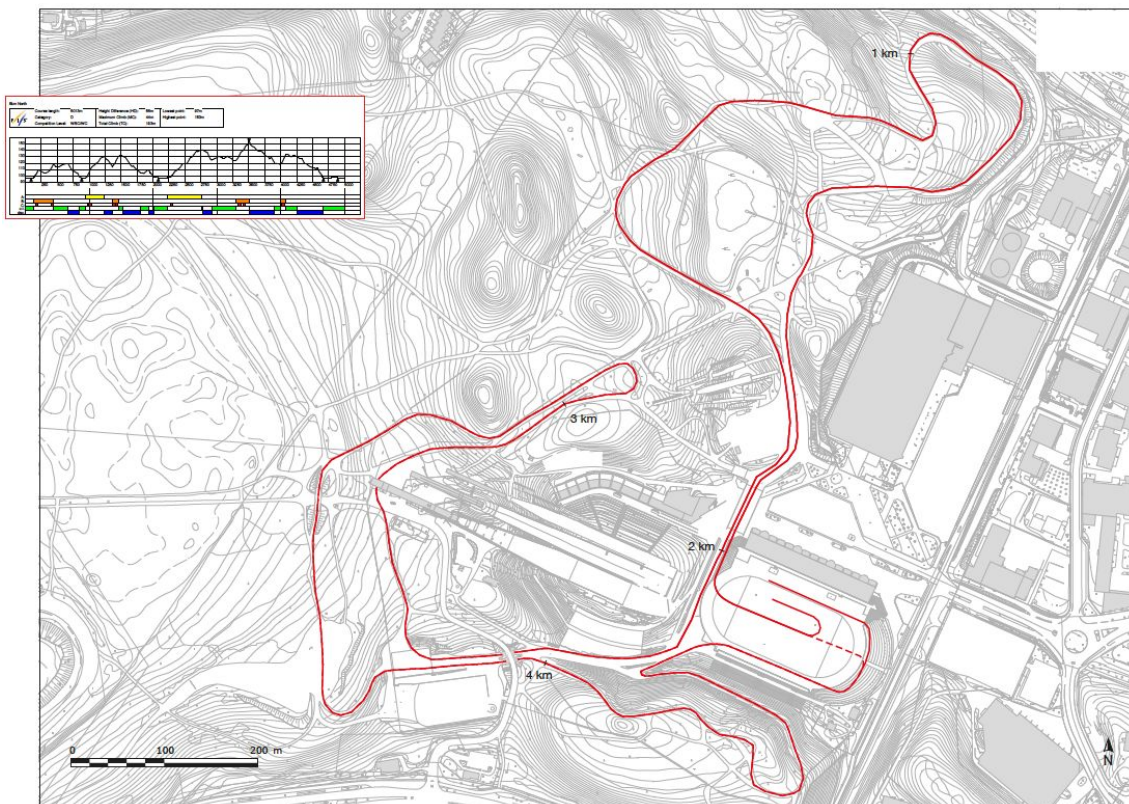

## Stadium layouts: Karpalo sprint / 5 km course

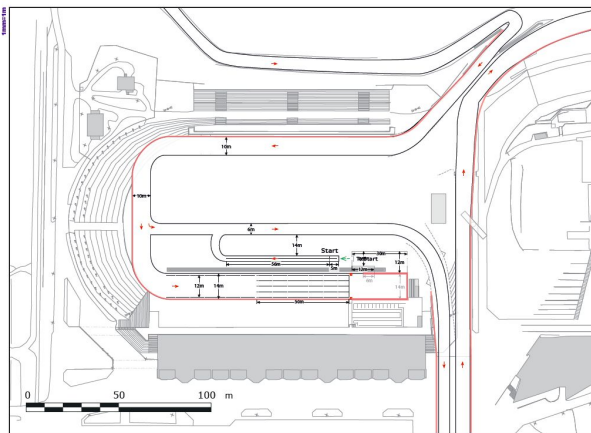
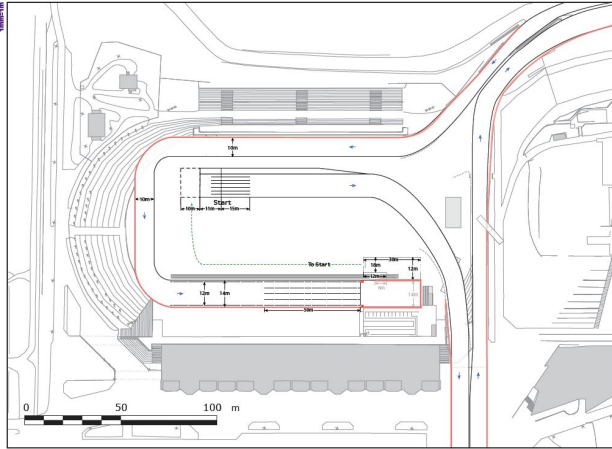

## Team hotel overview

Scandic Lahti:

[https://www.scandichotels.com/hotels/finland/lahti/scandic-lahti?\\_ga=2.41306469.674866337.1504073766-584210742.1499771836](https://www.scandichotels.com/hotels/finland/lahti/scandic-lahti?_ga=2.41306469.674866337.1504073766-584210742.1499771836)

Vierumäki Resort Hotel: (former Scandic Vierumäki)

<https://vierumaki.fi/en/accommodations/vierumaki-resort-hotel-standard-rooms>

**Drammen (NOR) - 07.03.2018**