

## Val Müstair (Switzerland) – 31.12- 01.1.2019

### Competition Program

Date	Format	Distance	Remarks
01/01/2019	Sprint F	1,4 km	Bonus Seconds for the athletes in the finals

### Event Program

Date	Competition	TCM	Other
Monday 31/12/2018		16:00h VIP Tent	20:00 New Year's Eve Party
Tuesday 01/01/2019	9:30h Quali 12:00h Sprint F		

### Contacts

Office	Name	Telephone	Email
General Secretary	Tobias Cueni	+41 81 861 88 44	info@tour-de-ski.ch
Accommodation office	Rolf Gubler	+41 81 858 55 51	info@hotel-al-rom.ch
Transportation office	Anton Waldner	+41 81 858 56 46 +41 79 954 68 79	anton.waldner@cdvm.ch
Race office	Bernhard Linder	+41 81 861 88 40	linder.bernhard@t-online.de
Financial office	Hans Rupp	+41(0) 81 851 62 62	hans.rupp@wps-revision.ch
Wax Cabins	Anton Waldner	+41 81 858 56 46 +41 79 954 68 79	anton.waldner@cdvm.ch

Truck driving permission (driving on holidays and sundays)		The LOC is negotiating with the customs and the police to simplify the process. We keep you updated.	info@tour-de-ski.ch
Customs		The LOC is negotiating with the customs and the police to simplify the process. We keep you updated.	info@tour-de-ski.ch

### Offices and their opening times

Office	Location	Opening times
Race office	Tschierv (school building on the race area)	30.12. - 02.12. daily from 08:00-18:30
Accommodation office	Tschierv (Hotel Al Rom)	opening Hours of the Hotel Al Rom
Transportation office	Tschierv (school building on the race area)	30.12. - 02.12. daily from 08:00-18:30
Accreditation office	Tschierv (school building on the race area)	30.12. - 02.12. daily from 08:00-18:30
Financial office	Hans Rupp, Tschierv	on demand

### Logistical information / Customs

Please enter and exit Switzerland over the crossing Müstair/Taufers. Only at this border customs clearance is guaranteed.

### Accommodation (World Cup Rules Art. 13)

- Booking according the FIS Rules via FIS Online registration system
- The OC offers following accommodation (full board included):
  - according to the FIS rules in the Valley and in South Tirol. Please note due to the time around New Years only bookings with two nights can be accepted. The Val Müstair is small and it is difficult to host such a big amount of people. So please fill out the registration form as soon as possible and contact the accommodation office to discuss the options.

### **Transport (World Cup Rules Art. 11)**

- Official airport : Zürich
- The organizing committee can arrange transportation between the last train station (Zernez) and the hotels.
- Information to the Shuttle service
  - (hotels – venue) : no transport according to the Tour Rules

### **Reimbursement (World Cup Rules Art. 10 and 13)**

- Accommodation costs:  
Over quota costs are to be paid by cash or credit card.
- Carrying costs/Reimbursement :
  - Expenses sheets will be received in financial office during the race weekend or by e-mail: Payments will be done by bank transfer.

### **Prize money payment (World Cup Rules Art. 8)**

- Due to data protection rules the data's from the athletes have to be given directly to: [t.cueni@val-mue stair.ch](mailto:t.cueni@val-mue stair.ch)
- Prize money from is available on FIS Website under:  
<http://www.fis-ski.com/inside-fis/document-library/cross-country/#deeplink=forms>

### **Income tax information for prize money:**

- Income tax of European citizen is 15%
- Income tax of non-European citizen is 15% (USA 0 %)

### **Waxing facilities (World Cup Rules Art. 14)**

- Wax cabins : available from 20/11/2017 at 12 :00
- Waxing trucks : teams arriving with trucks have to inform the OC before 12/10/2017
- The keys to the cabins are available at the competition office. The deposit is 100 €/team. Keys return to Ski Cafe/service area on the day of departure.

### **Regulations of radio equipment/Radio Frequencies:**

## Regulations of Visa:

### Special permissions for truck driving (Sunday- and night, other days with special regulations)

Please fill out this Form until the End of October. Afterwards we can request a permission .

<https://docs.google.com/forms/d/e/1FAIpQLSeonic3Zueo9kJ35n6GO2ii5XEdnrZZ-BR8fJHcJXMci5Z3Q/viewform>

### Special advices for the route and roads

The journey will take you around 210 km. Please have your documents and permits ready for the Swiss border (see above).

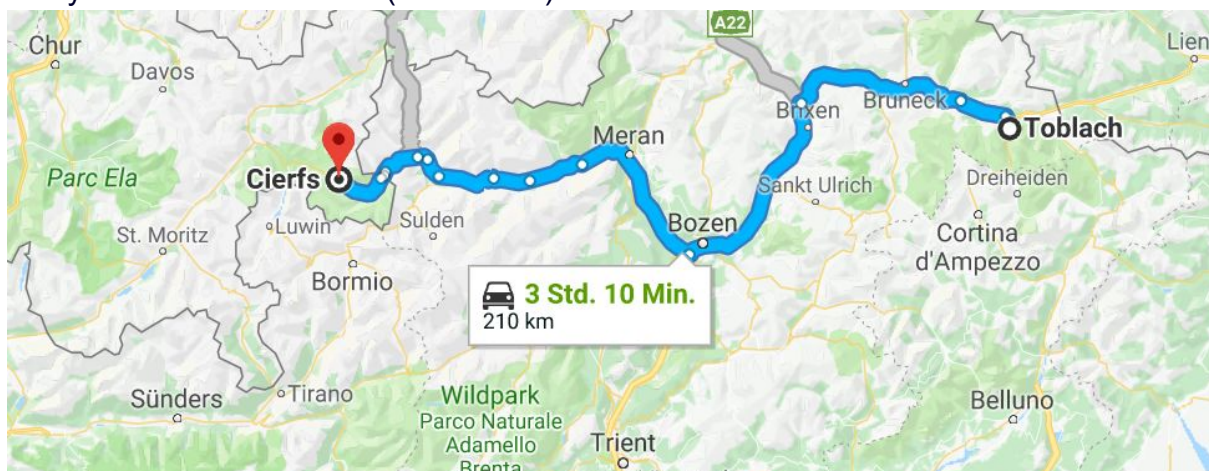

## Team Hotel overview:

## Maps and Courses

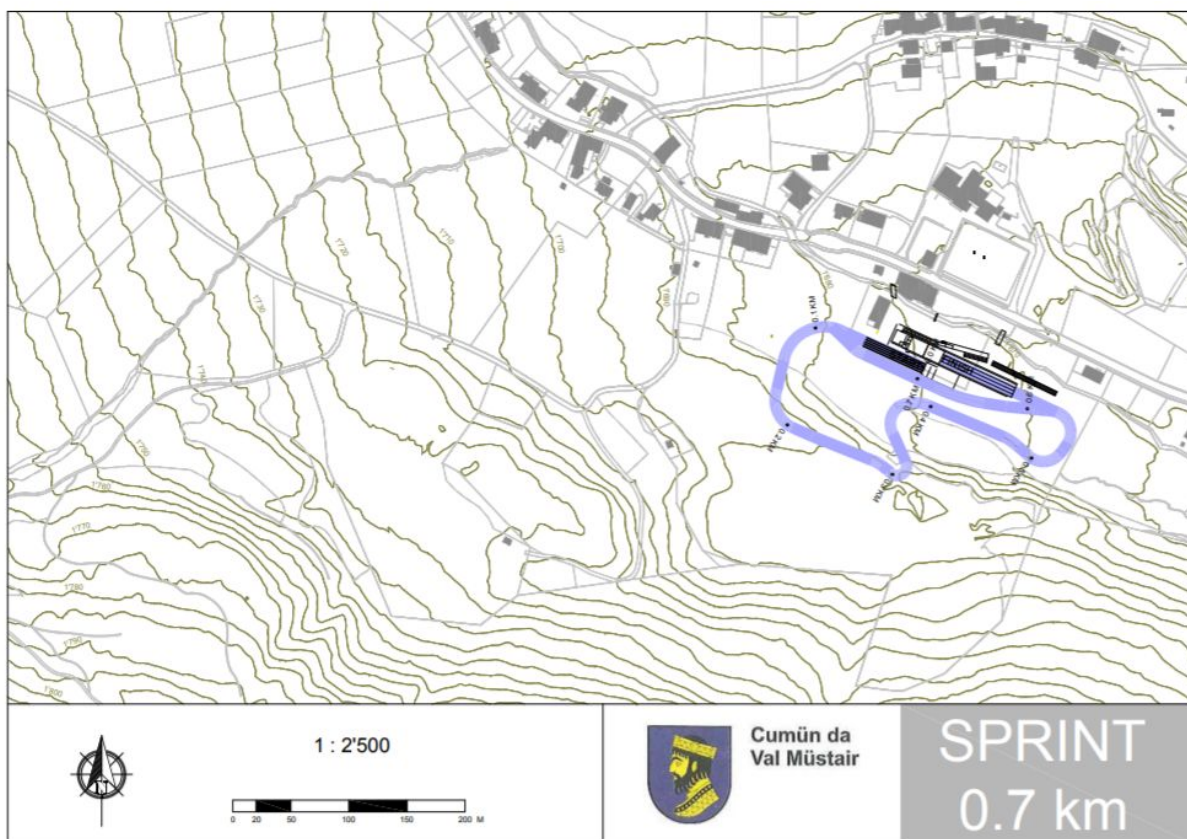

Website: [www.tour-de-ski.ch](http://www.tour-de-ski.ch)

Facebook: <https://www.facebook.com/TourDeSkiValMuestair>